

# Grain Cart Grain Door Cylinder Enclosure



## Inventory

### Required Hardware

- (1) Front Cylinder Housing P# 85798
- (1) Rear Cylinder Housing P# 85799
- (6) 3/8" X 1" Bolt P# 1206
- (6) 3/8" Whiz Nut P# 2082
- (5) 9" Tie Wraps

### Required Tools / Equipment

Wrenches      Side Cutters

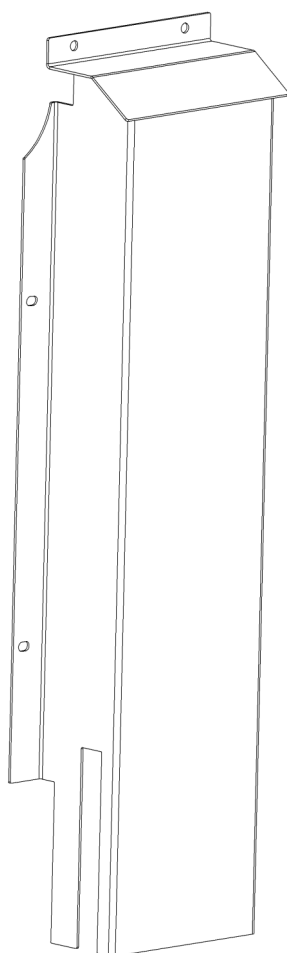

**P# 85798**  
**Front Cylinder**  
**Housing**

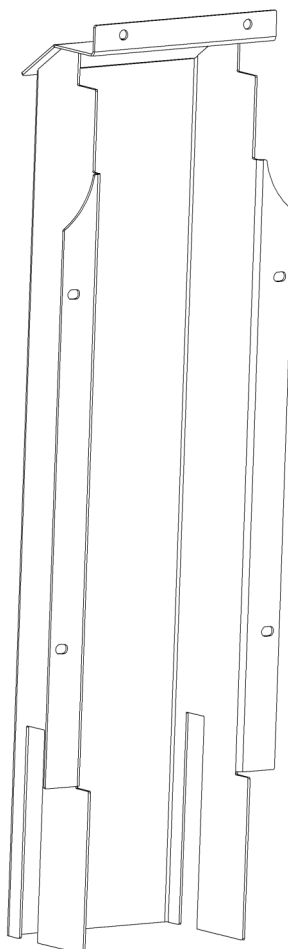

**P# 85799**  
**Rear Cylinder**  
**Housing**



**P# 1206**  
**BOLT HEXHEAD**  
**.37" x 1.00" - UNC 16 GR5**



**P# 2082**  
**NUT WHIZ**  
**.37" - 16 UNC**



**9" Tie Wraps**

# Grain Cart Grain Door Cylinder Enclosure



## Installation

### Required Hardware

N/A

### Required Tools / Equipment

N/A

The following procedure will allow the end user to install the Grain Door Hydraulic Cylinder Enclosure. The grain cart should be completely empty before completing this installation. The two hydraulic hoses which control the grain doors, need to be exposed. See Figure 1.

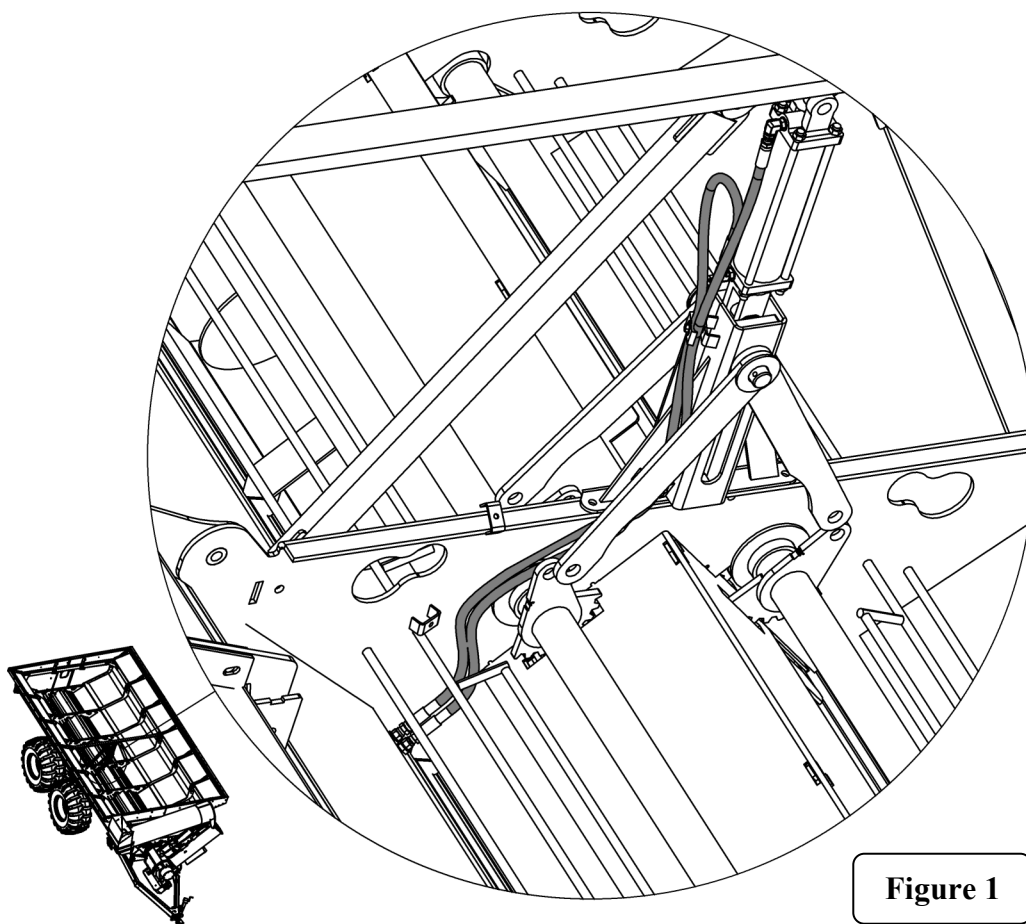

**Figure 1**

# Grain Cart Grain Door Cylinder Enclosure



## Installation

### Required Hardware

N/A

### Required Tools / Equipment

Wrenches

If lower hydraulic hose is installed in the orientation displayed in Figure 2, it must be rotated to face downward. See Figure 3.

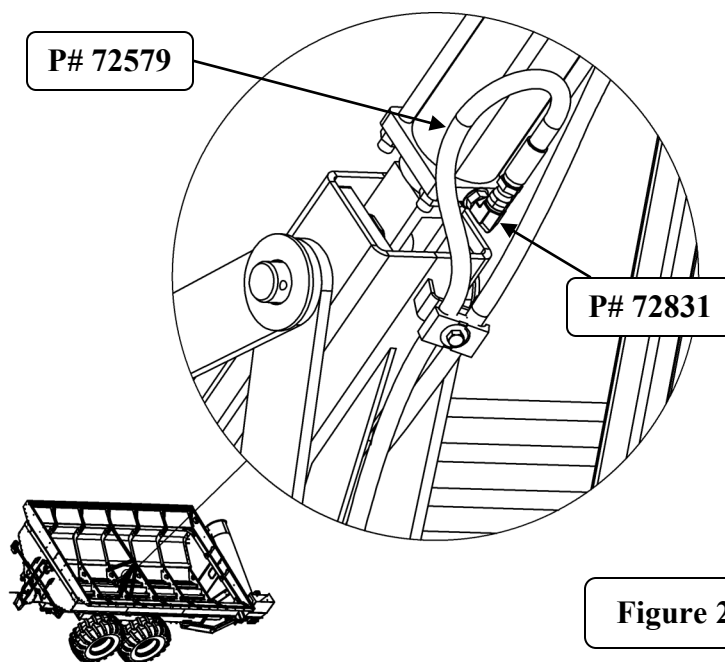

Figure 2

Remove hydraulic hose P# 72579. Loosen hydraulic elbow P# 72831 and rotate to face down. See Figure 3.

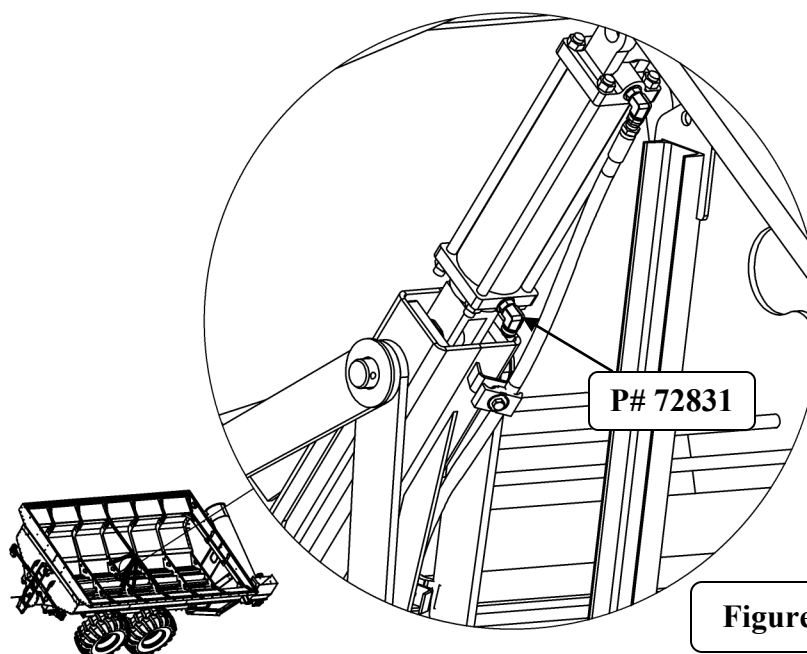

Figure 3

# Grain Cart Grain Door Cylinder Enclosure



## Installation

### Required Hardware

Tie Wraps

### Required Tools / Equipment

Wrenches

Side Cutters

Reattach hydraulic hose P# 72579 to hydraulic elbow P# 72831 tighten fittings. See Figure 4.

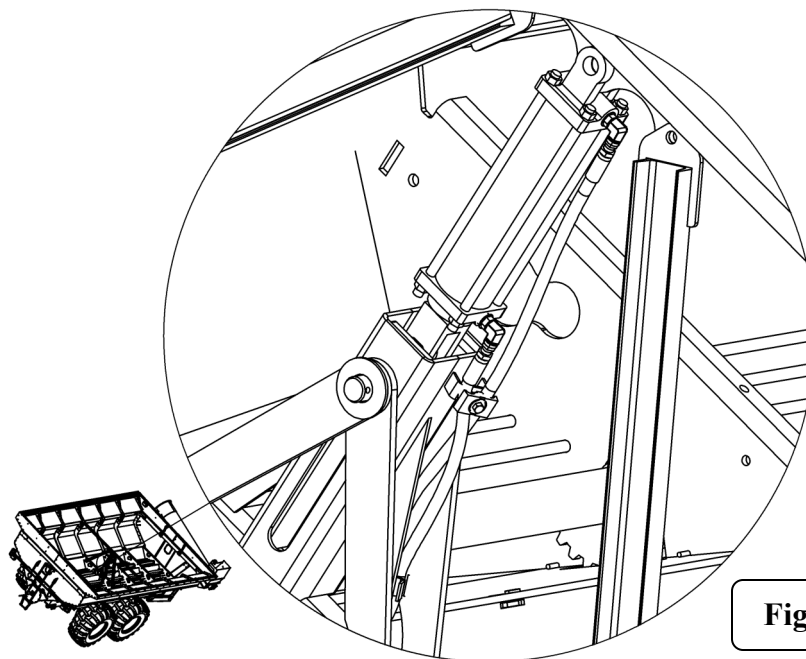

Figure 4

Use tie wraps to secure hydraulic hoses and pull and potentially binding slack out of the way. See Figure 5.

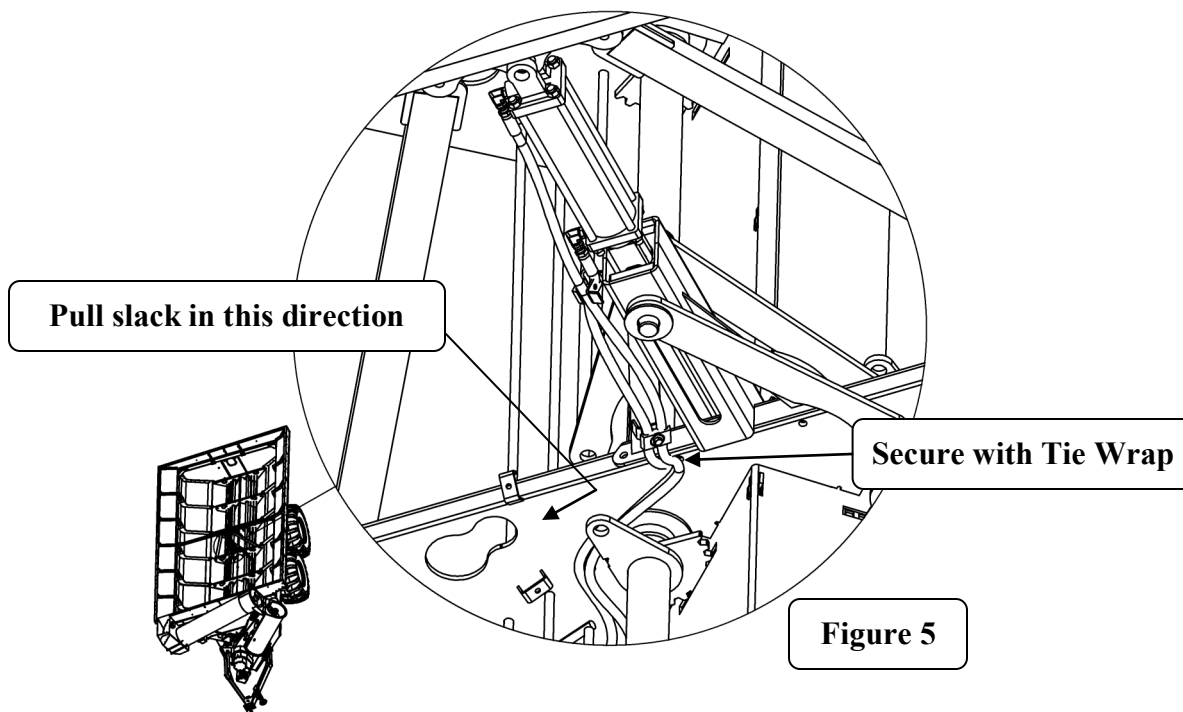

Figure 5

# Grain Cart Grain Door Cylinder Enclosure



## Installation

### Required Hardware

- (1) Front Cylinder Housing P# 85798
- (2) Rear Cylinder Housing P# 85799
- (6) 3/8" X 1" Bolt P# 1206
- (6) 3/8" Whiz Nut P# 2082

### Required Tools / Equipment

Wrenches

Slide front cylinder housing cover P# 85798 over connecting arms. Slide rear cylinder housing cover P# 85799 over connecting arms. Secure with bolts P# 1206 and whiz nuts P# 2082. See Figures 5 and 6.

