

ENGINEERING BULLETIN

Grain Cart Directional Downspout Hydraulic Orifice Update

The following procedure will install a speed regulating orifice in order to improve the operation of the directional downspout.

Required Hardware

(1) HYD Restrictor P# 71370

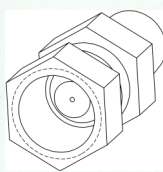

P# 71370
HYD RESTRICTOR
.25NPTMx .25NPTFMS .031
(RST1404 4-4-R.031)

Required Tools / Equipment

Wrenches

Remove hydraulic hose P# 72107. See Figure 1.

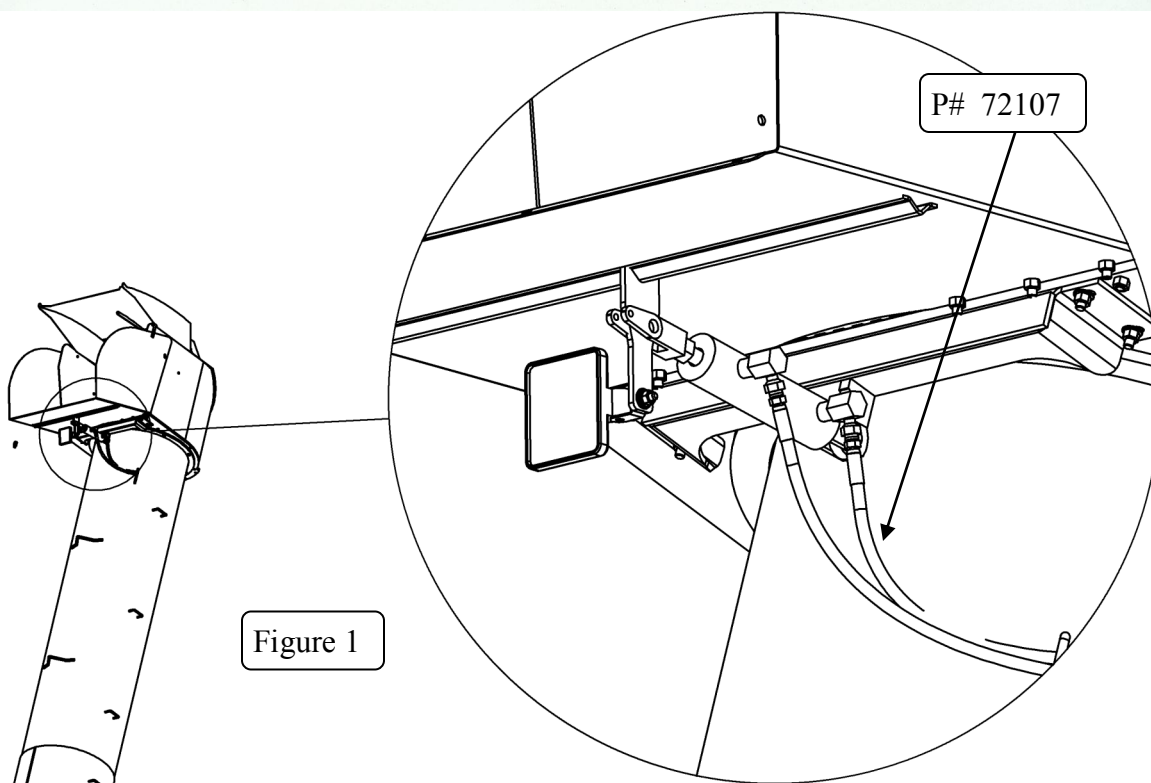

RELEASE DATE: 9/21/2010



ENGINEERING BULLETIN

Install hydraulic orifice P# 71370 onto hydraulic fitting P# 21201. Reinstall hydraulic hose P# 72107. Tighten all fittings. See Figure 2.

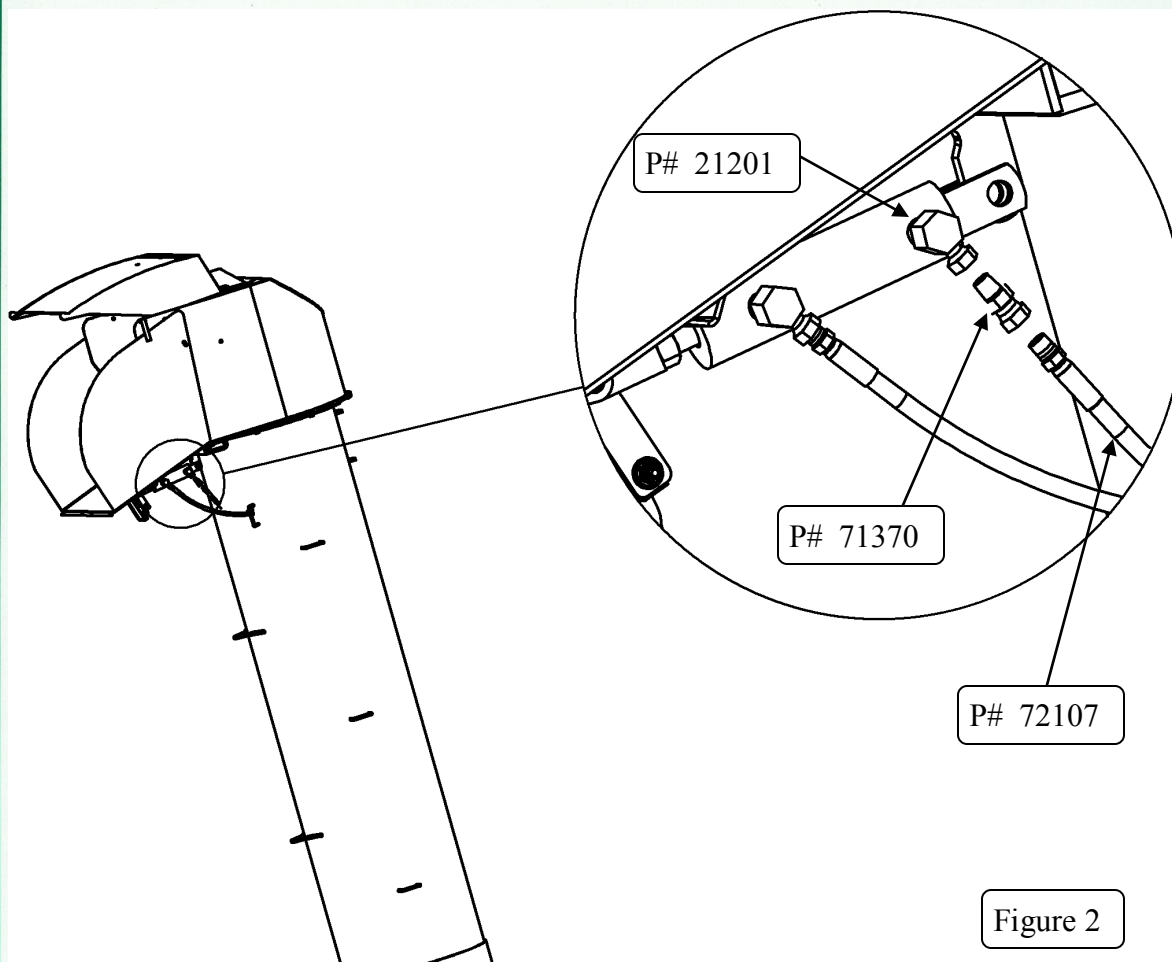

RELEASE DATE: 9/21/2010